



STEEL DOOR & FRAME SYSTEMS, INC.

Single Panel Doors SP1900 Series

Standard Features

- ◆ 18 Gauge Galvanized Steel
- ◆ Seamless Filled Edges
(Edge/Corner Seam Construction)
- ◆ Full Body Polystyrene Core
- ◆ Non-Handed Design
- ◆ 12-Gauge Closer Reinforcement
- ◆ 7-Gauge Hinge Reinforcement-
Standard / Heavy Duty
- ◆ 16-Gauge Flush Top Cap - Galvanized
- ◆ 16-Gauge Inverted Bottom Cap - Galvanized
- ◆ ADA 10 inch Minimum Bottom Rail
- ◆ Prime Painted Grey Two Part
Epoxy Factory Applied, Baked On
- ◆ Standard Lock Preparations
Include 161, 161-DL, Fed 86 Edge,
Panic Bar Reinforcement
- ◆ WHI / ITS up to 3 hour,
Positive Pressure and
"S" Smoke included
- ◆ STC Rated 28, Model 32-1900
STC Rated 32
- ◆ Meets or Exceeds Standards for
ANSI 250.4 and ANSI 250.8

Typical Hardware Preparations

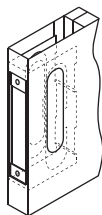

ANSI / SDI A115.1
"MB" (MORTISE)

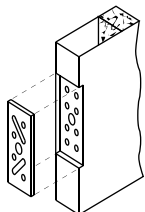

NON-HANDED HINGE

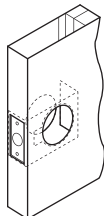

ANSI / SDI A115.2
"C" (BORED)

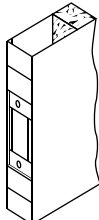

UNIVERSAL STRIKE
A115.1 "U"

SECTION Y-Y

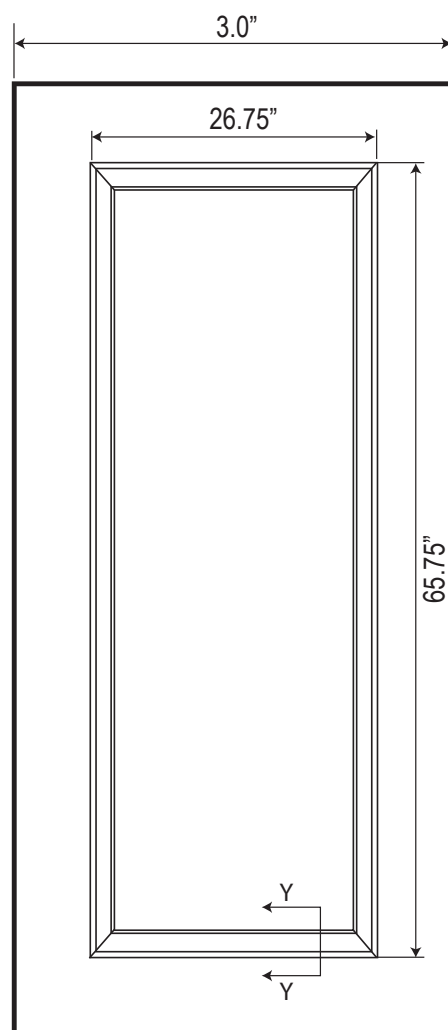
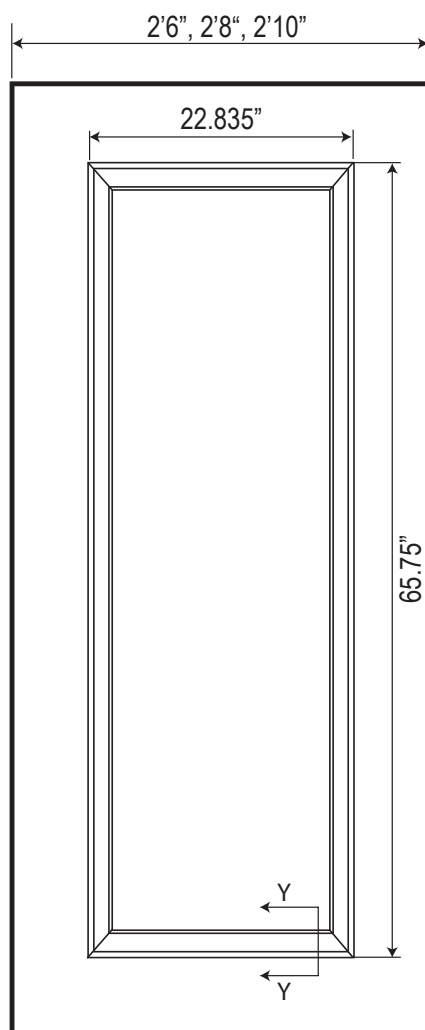
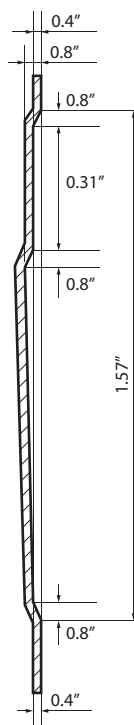

DKS Steel Door & Frame Systems, Inc.

2142 Tubeway Avenue, Commerce, CA 90040 ◆ Tel: (323) 888-7763 ◆ Fax: (323) 888-0063 ◆ Email: sales@dksdoors.com ◆ Website: www.dksdoors.com